

Sustainability

The legacy of house building over the past 50 years has meant the perception of new development is extremely negative. Central Government and Local Planning Authorities have recognised the problem and organisations such as The Prince's Foundation are now at the forefront of changing this. The demand for housing can be seen as an opportunity to make amends for the past and create communities which are sustainable. In essence this means places:

- where people want to live and work, now and in the future;
- that meet the diverse needs of existing and future residents;
- that are sensitive to their environment, and contribute to a high quality of life; and
- that are safe and inclusive, well planned, built and run, and offer equality of opportunity and good services for all.

Sherford seeks to meet all these criteria and more.



Greenpeace diagram on efficient methods of energy and renewable energy generation



Sustainable lifestyles: cycling to school (source: www.sustrans.org.uk)



Wincanton farmers market

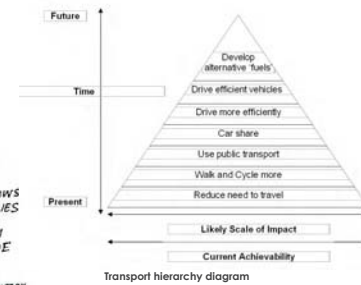
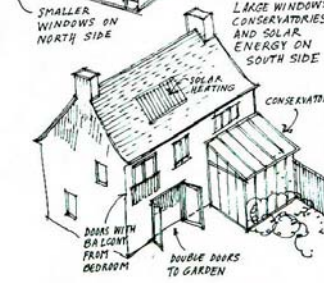
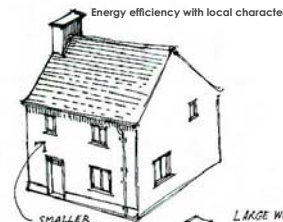

Green roofs alleviate flooding and provide habitats for local wildlife

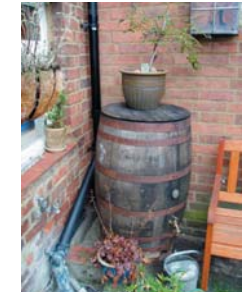

At the simplest level, rainwater can be collected in a water butt for garden use



"Every BedZed home incorporates a colour coded, segregated under-sink bin" (source www.bioregional.com)

Sensitive to the Environment

Sherford is being designed and planned at a time when our news headlines are filled with talk of "climate change" and how we need to act now to prevent our children and their children suffering in the future. The main focus is carbon dioxide emissions and how to reduce them substantially if we are to try and halt or slow down climate change.

If Sherford is to try and address this issue then a major reduction in carbon emissions should be designed into the project as a fundamental principle. This has been taken on board by Red Tree and the masterplanning and design team, the local community and interested stakeholders. As a result the following areas are now being looked at for ways in which they can contribute to carbon reductions:

- travel and transport;
- local and sustainable food;
- building performance and energy efficiency;
- efficient methods of energy and renewable energy generation;
- waste management and minimisation;
- local and sustainable materials;
- water use and management of waste water;
- enhancing and creating natural habitats for wildlife resulting in a net gain from the current situation; and
- education/encouragement within the community to lead more sustainable lifestyles.

The way the Town Plan is designed is crucial to achieving these objectives.

SHERFORD



PUBLIC EXHIBITION