

- NOTES**
- 1 THIS DRAWING IS TO BE READ IN CONJUNCTION WITH ALL RELEVANT ARCHITECT'S, ENGINEERS, SERVICES AND SPECIALIST DRAWINGS AND SPECIFICATIONS
 - 2 ANY DISCREPANCIES IN DIMENSIONS OR DETAILS BETWEEN THE DRAWINGS SHOULD BE DRAWN TO THE ATTENTION OF THE ENGINEER IN WRITING FOR CLARIFICATION.
 - 3 UNLESS OTHERWISE STATED ALL LEVELS ARE IN METRES AND RELATE TO THE SITE SURVEY.
 - 4 ALL ROADWORKS TO BE IN ACCORDANCE WITH THE HIGHWAY AGENCY SPECIFICATION FOR HIGHWAY WORKS, TOGETHER WITH ANY REQUIREMENTS OF THE LOCAL HIGHWAY AUTHORITY.
 - 5 ALL ADAPTABLE SEWERS TO BE CONSTRUCTED IN ACCORDANCE WITH SEWERS FOR ADOPTION 5th EDITION AND SPECIFIC REQUIREMENTS OF SOUTH WEST WATER.
 - 6 ALL HIGHWAY BOUNDARIES TO BE CLOSED OFF WITH APPROVED CONCRETED CURBS AND OTHER EDGE TREATMENT SUCH AS WALLS, HEDGES AND MORE SUBSTANTIAL FENCING TO BE PROVIDED WHERE AGREED.
 - 7 ACCESS TO ONSITE PROPERTIES AND CROSS-SITE CONNECTIONS TO BE PROVIDED THROUGHOUT THE MAIN STREET WORKS.

PROPOSED JUNCTION IMPROVEMENT INVOLVING THE CONVERSION OF THE EXISTING PRIORITY JUNCTION TO A SIGNALISED JUNCTION

DEEP LANE NORTH

PROPOSED CONTROLLED CROSSING

EXISTING WESTBOUND MERGE SLIP ROAD TO BE REMOVED
CONNECT INTO EXISTING STORM SEWER

PROPOSED WIDENING OF EXISTING CARRIAGEWAY TO ENABLE WESTBOUND DIVERGE SLIP ROAD TO BE UPGRADED TO PROVIDE 3.65m WIDE LANES WITH 1.0m WIDE HARDSTRIPS (DGZE)

NEW RETAINING WALL TO BE PROVIDED ON THE SOUTH EASTERN SIDE OF WESTBOUND DIVERGE LOOP TO ENABLE THE EXISTING CUTTING SLOPE TO BE RETAINED IN THE AREA WHERE THE SLIPROAD IS TO BE WIDENED. THE RETAINING WALL SHALL BE PROTECTED WITH A ROAD RESTRAINT SYSTEM WITH A CONTAINMENT LEVEL OF N2 AND WORKING WIDTH OF W4.

PROPOSED IMPROVEMENT TO EXISTING LOOP INVOLVING CARRIAGEWAY WIDENING TO ENABLE FOUR LANES TO BE PROVIDED ON THE WESTBOUND APPROACH TO THE JUNCTION

DEVON HEDGEBANK TO BE REINSTATED OVER THE WESTERN END OF THE ROAD TO ENABLE THE EXISTING ACCESS TO BE CLOSED OFF. TRAFFIC SIGNS / BOLLARDS SHALL BE PROVIDED AT EASTERN END TO PROHIBIT ALL VEHICULAR ACCESS OTHER THAN FARM VEHICLES

PROPOSED CONTROLLED CROSSING

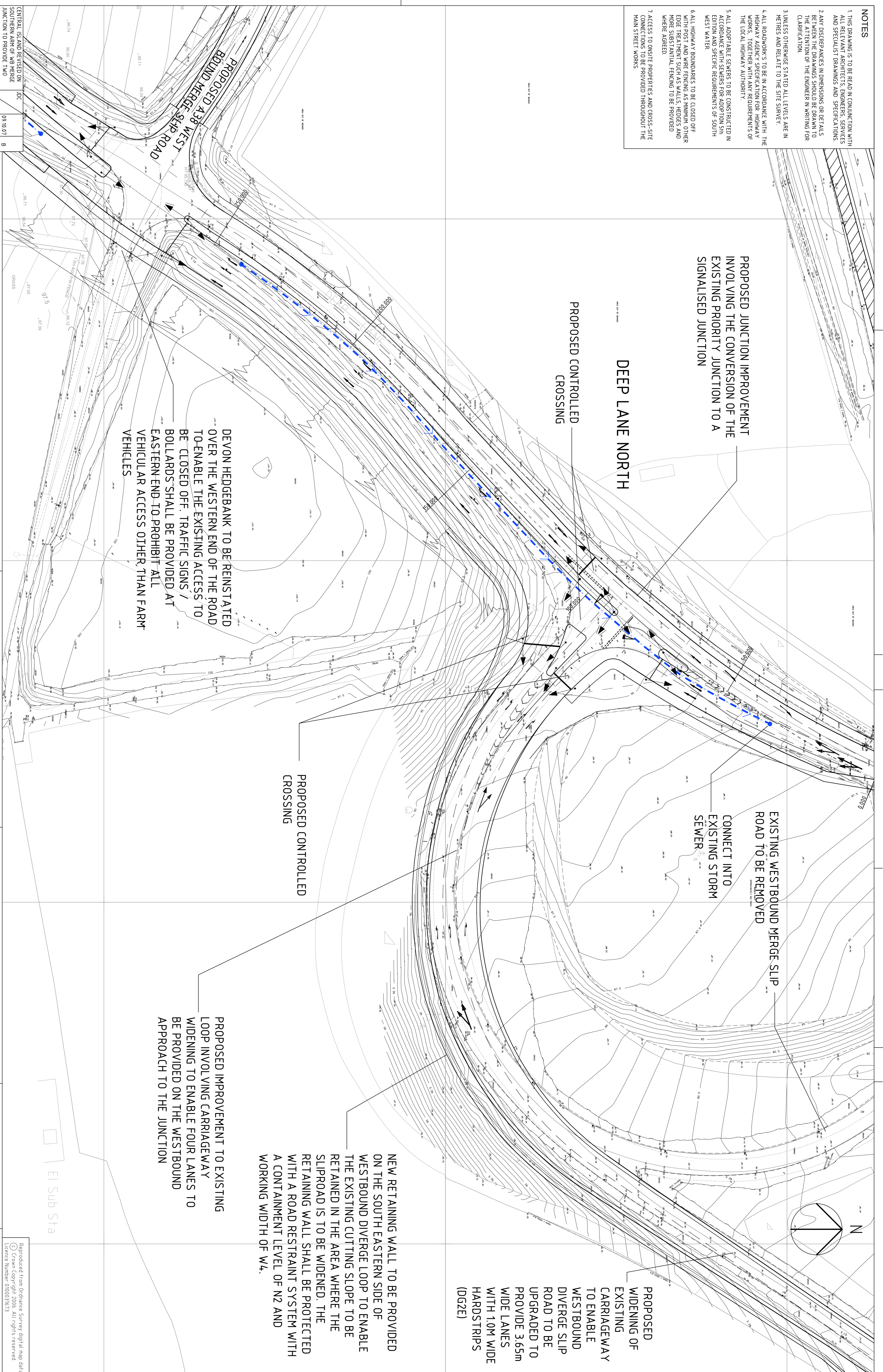

- KEY**
- PROPOSED STORM WATER DRAINAGE
 - JUNCTION VISIBILITY SPLAY

Revision Details	By	Date	Signif.
WESTBOUND DIVERGE SLIP ROAD	JDC	19.09.07	A
REVISION NOTES ADDED	JR	09.10.07	B
CENTRAL ISLAND REVISED ON SOUTHERN ARM OF WB MERGE JUNCTION TO PROVIDE TWO AHEAD LANES, PED CROSSINGS	JDC	09.10.07	B

Plot Date :	
AutoCAD File Name :	
Drawing Status	PRELIMINARY

Job Title	SHERFORD
-----------	-----------------

Drawing Title	PROPOSED ROAD LAYOUT MAIN STREET FROM DEEP LANE TO STANBOROUGH CROSS SHEET 2 OF 13
---------------	---

Scale at A1	1:500, 1:1000 AT A3
Drawn	JDC
Stage 1 check	AB
Stage 2 check	AB
Originated	JDC
Date	OCT 06

Drawing Number	D108875-703
Rev	B

Reproduced from Ordnance Survey digital map data
© Crown Copyright 2006. All rights reserved.
Licence Number 0100031673

Scott Wilson
Basing View, Basingstoke
Telephone 01256 461161
Fax 01256 460582
www.scotwilson.com



THIS DRAWING MAY BE USED ONLY FOR THE PURPOSES INTENDED AND ONLY THE WRITTEN DIMENSIONS SHALL BE USED